

RD

Sandusky, Michigan Kmart Shopping Center

Management LLC

Location: Kmart Shopping Center is located at West Sanilac Road (Highway M 46) and Gates Road in Sandusky, Michigan 48471.

Type: Community Strip Shopping Center

GLA: 150,204 square feet

Parking: 1,075 cars

Traffic: Two way average daily traffic 14,300 cars per day

Demographics:	3 miles	5 miles	10 miles
Population	4,226	5,396	12,798
Households	1,672	2,099	4,817
Average HH Income	\$48,011	\$48,613	\$48,914

Major Tenants: Kmart 91,266 square feet

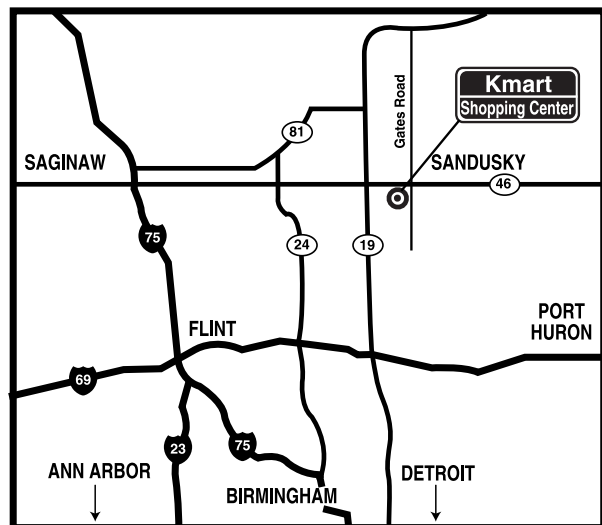

RD Management LLC

810 Seventh Avenue, 28th floor
New York, NY 10019
1-800-2-OCCUPY
212-265-6600 x239
Thomas G. Mirandi
212-265-8250 fax
tmirandi@rdmanagement.com

Information furnished is from sources deemed reliable, but is not guaranteed by RD Management and is subject to change in price, corrections, errors and omissions, prior sales or withdrawal without notice.

Kmart Shopping Center

West Samilac Road (HWY M 46) and Gates Road

Sandusky, Michigan 48471

RD Management LLC

810 Seventh Avenue, 28th floor
New York, NY 10019
1-800-2-OCCUPY
212-265-6600 x239
Thomas G. Mirandi
212-265-8250 fax
tmirandi@rdmanagement.com

- 1. Kmart 91,266 sf
- 2. Available 10,200 sf
- 3. Employment Office 3,000 sf
- 4. Available 3,600 sf
- 5. Available 34,138 sf
- 6. Continental Rental 6,000 sf
- 7. Available 700 sf
- 8. Available 1,300 sf

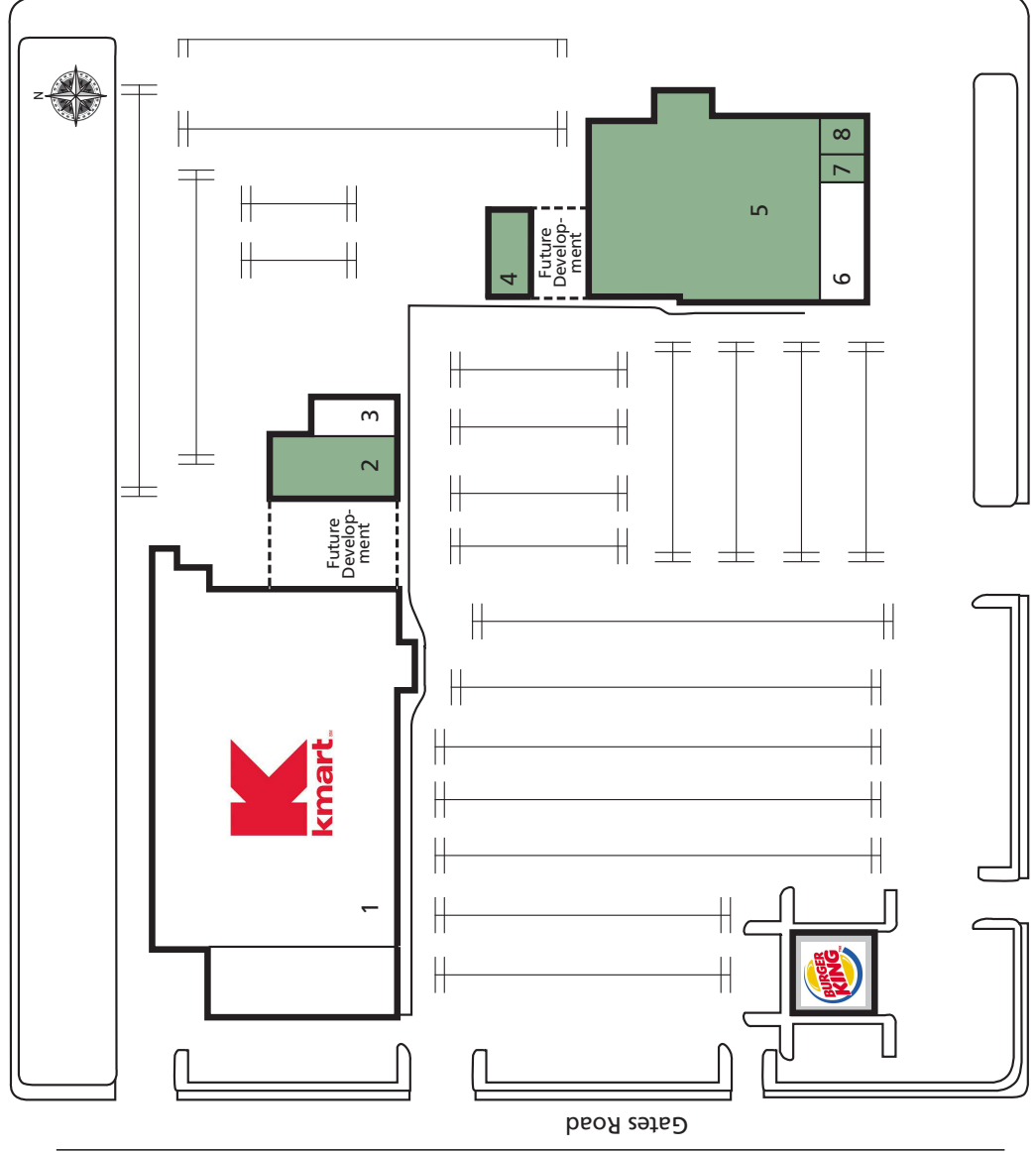

04/08
FE489

Information furnished is from sources deemed reliable, but is not guaranteed by RD Management and is subject to change in price, corrections, errors and omissions, prior sales or withdrawal without notice.