

# The Shoppes and Residences at Renaissance Square

State Highway 70 and N. Locust Avenue  
Evesham (Marlton), New Jersey 08053



**Darren Sasso**  
212-265-6600 x354  
dsasso@rdmanagement.com  
810 Seventh Avenue, 10th floor  
New York, NY 10019

Plenary Retail Consumption Liquor License available

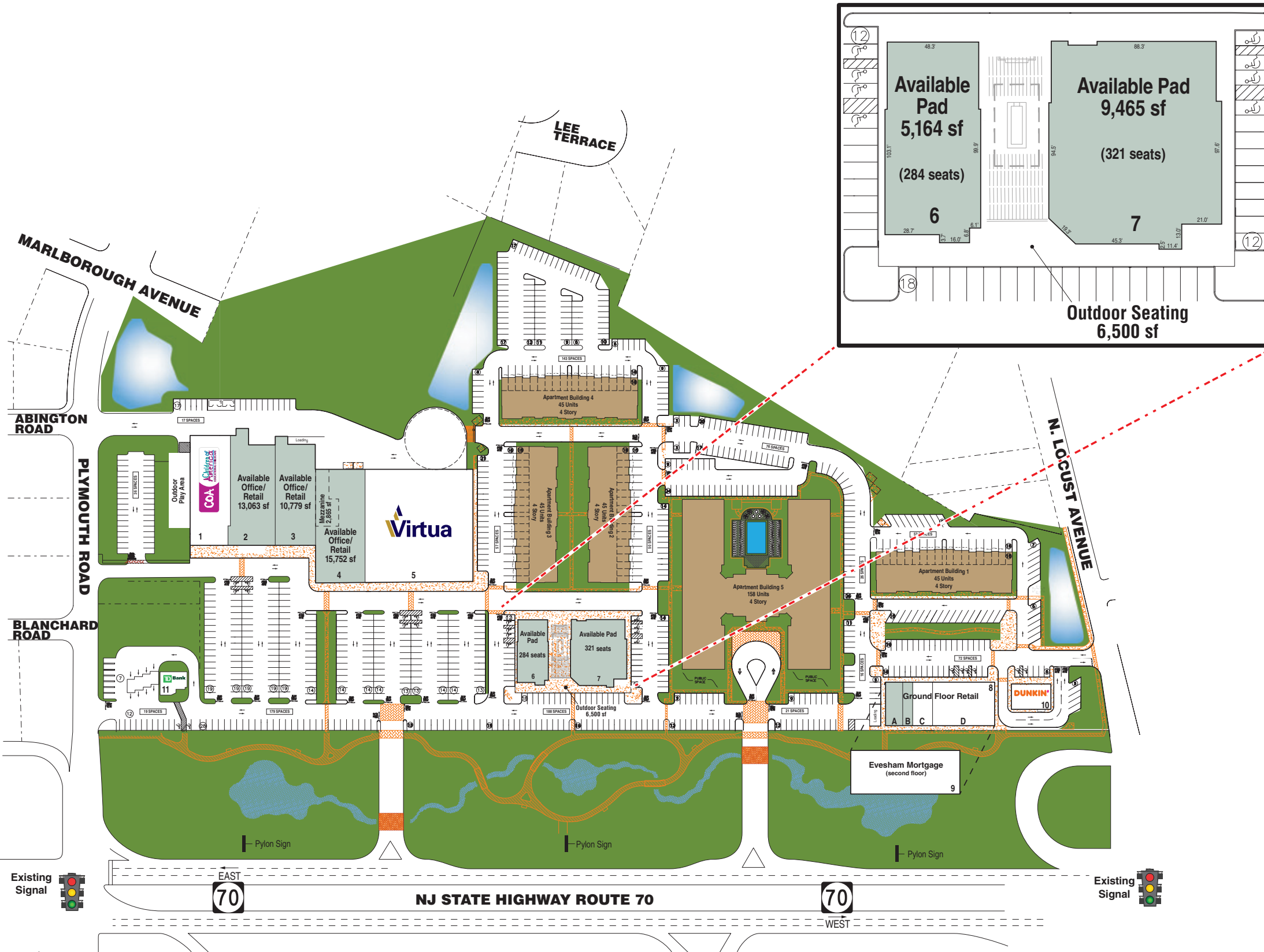

### Tenant Key

1. Children of America		10,126 sf
2. Available Office/Retail	(84' x 165.5' irr.)	13,063 sf
3. Available Office/Retail	(65' x 165.5' irr.)	10,779 sf
4. Available Office/Retail	(84.5' x 185.5' irr.)	15,752 sf
Mezzanine		2,865 sf
5. Virtua Medical Group		32,568 sf
6. Available Restaurant Pad	(50.8' x 103.1' irr.)	5,164 sf
7. Available Restaurant Pad	(97' x 97.6' irr.)	9,465 sf
8. Ground Floor Retail Strip		
A. Available	(30' x 70')	2,070 sf
B. Available	(15' x 70')	1,050 sf
C. Pink Petal Mani		1,984 sf
D. Keller Williams Real Estate		6,387 sf
9. Evesham Mortgage		12,753 sf
10. Dunkin Donuts		2,600 sf
11. TD Bank (Existing)		1,300 sf

### RESIDENTIAL KEY

Apartment Building 1	45 Units
Apartment Building 2	45 Units
Apartment Building 3	45 Units
Apartment Building 4	45 Units
Apartment Building 5	158 Units
<b>Total Apartments</b>	<b>338 Units</b>

